

**TAYLOR WINGS INC
INSTALLATION INSTRUCTIONS FOR
TP9 FUEL TRANSFER PUMP SYSTEM.
EZ-8RVS 9 GPM**

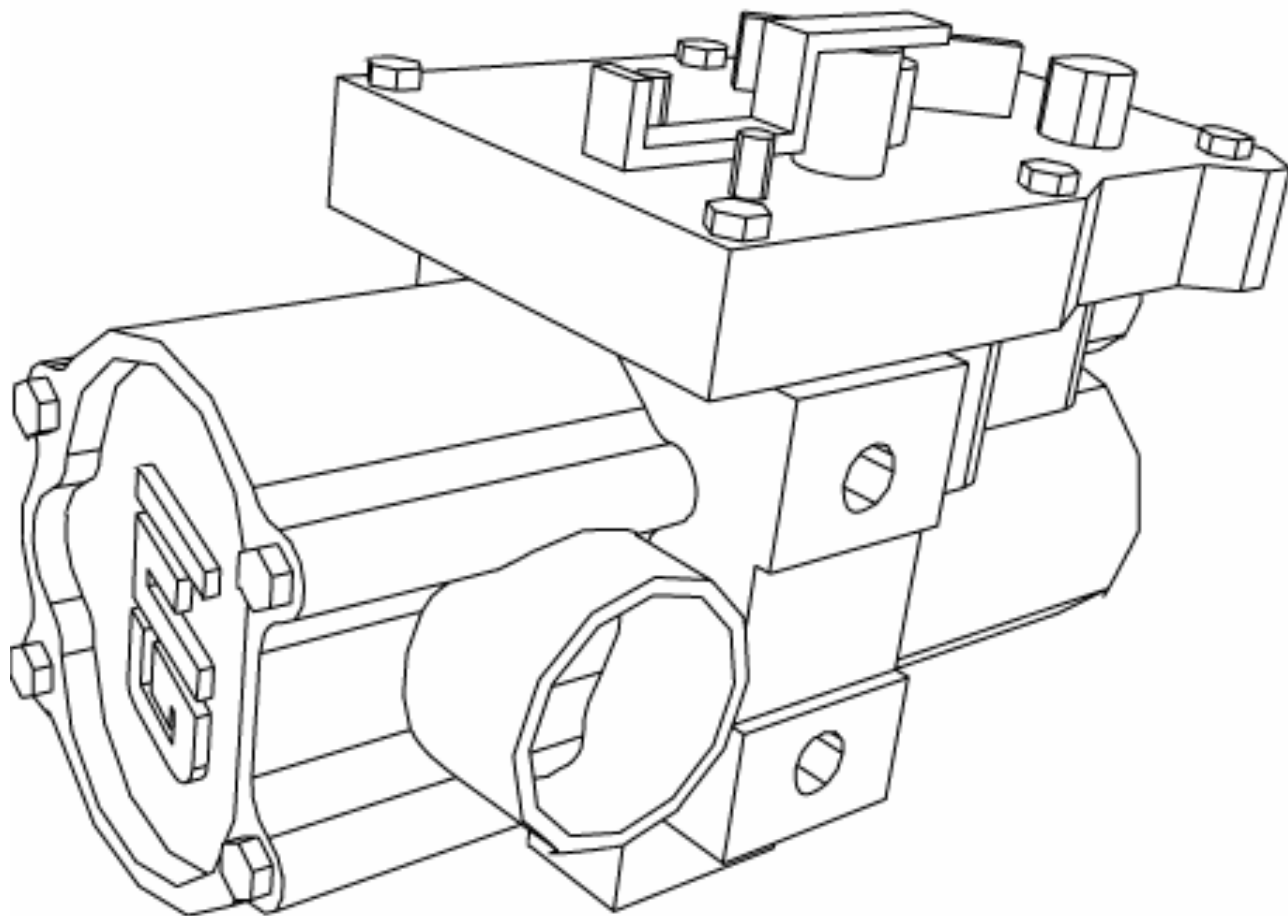

C *UL* US LISTED Electric Motor For Hazardous Locations Class I Group D

12 VOLTS DC	PM FIELD	40 DEG C AMBIENT
2100 RPM	75 DEG C RISE	15 MIN ON/ 30 MIN OFF
1/10 H.P.	11 AMPS	OP. TEMP. CODE T2C

These instructions will guide you through the installation of the Taylor Wings TP9 Fuel Transfer Pump system. This system is designed for Taylor Wings Auxiliary Diesel Fuel tanks only, and should not be altered or modified in any way.

PARTS REQUIRED FOR TP9 INSTALLATION:

ITEM	QTY	ITEM DESCRIPTION
1	1	EZ-8RVS GPI ALUMINUM 9GPM PUMP
2	1	10' PUMP HOSE
3	1	GPI ALUMINUM MANUAL NOZZLE
4	1	PICK-UP ADAPTER
5	1	NYLON BARBED TUBE FITTING 3/8" MPT- 1/2" TUBE I.D.
6	1	NYLON BARBED ELBOW TUBE FITTING 3/8" MPT- 1/2" TUBE I.D.
7	1	NYLON 1" MPT X 3/4" FPT REDUCING HEX BUSHING
8	1	NYLON BARBED TUBE FITTING 3/4" MPT - 1/2" TUBE I.D.
9	1	24" SECTION OF 1/2" I.D. FUEL HOSE
10	1	12" SECTION OF 1/2" I.D. FUEL PICK-UP HOSE
11	2	5/16"-7/8" HOSE CLAMP
12	1	15' SECTION OF 12VDC CORD
13	1	CORDGRIP
14	2	BUTT-CONNECTOR
15	1	PUMP MOUNTING BRACKET (INCLUDED WITH T.W. TOOLBOXES)
16	2	3/8"-1/2" HEX BOLT
17	2	1/4"-20 x 1" HEX BOLT
18	4	1/4" WASHER
19	2	1/4"-20 LOCK NUT

TOOLS REQUIRED FOR INSTALLATION:

PHILLIPS SCREWDRIVER
7/16" SOCKET WRENCHES OR END WRENCHES
9/16" SOCKET WRENCH OR END WRENCH
7/8" END WRENCH
11/16" END WRENCH
12" CRESCENT WRENCH
SLOTTED SCREWDRIVER
1/4" SOCKET AND DRIVER
1/4" DRILL

1. IDENTIFYING THE SENDING UNIT PLATE:

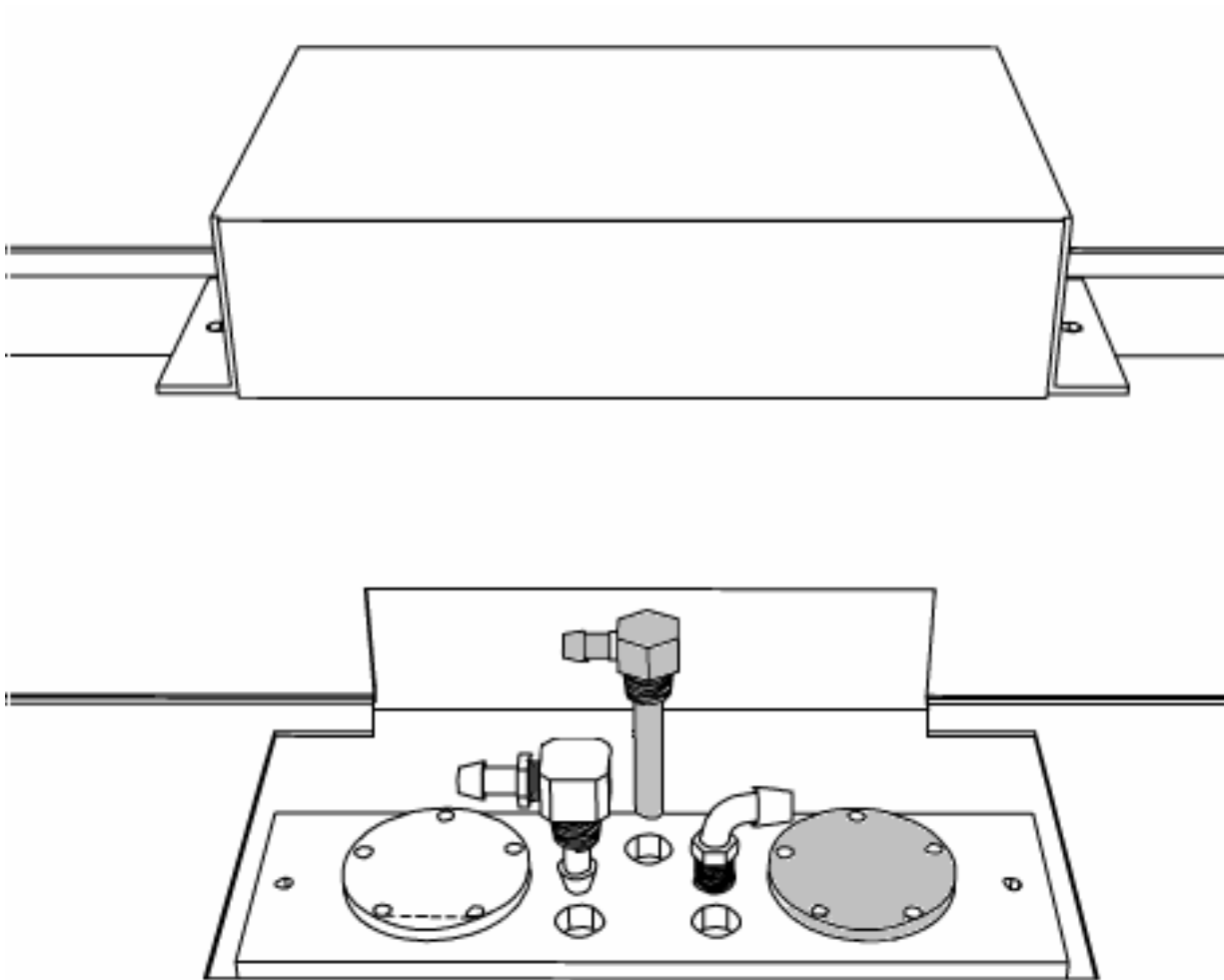

Remove the Sending Unit Cover by removing the 2 screws on either side of the cover exposing the Sending Unit Plate. Your Taylor Wings Auxiliary Tank has two caps fastened with five 8-32 machine screws, and three 3/8" FPT holes in-between. *If you have purchased additionally the Taylor Wings AFC Fuel Controller system, additional fittings may be installed on the Sending Unit Plate.* Be sure that the Brass Rollover Valve/ Breather Vent (shown shaded center) is located in the center. Remove the five machine screws from the passenger side cap (shown shaded right) and discard the cap.

2. PLUMBING THE TP9 FUEL PICKUP ADAPTER.

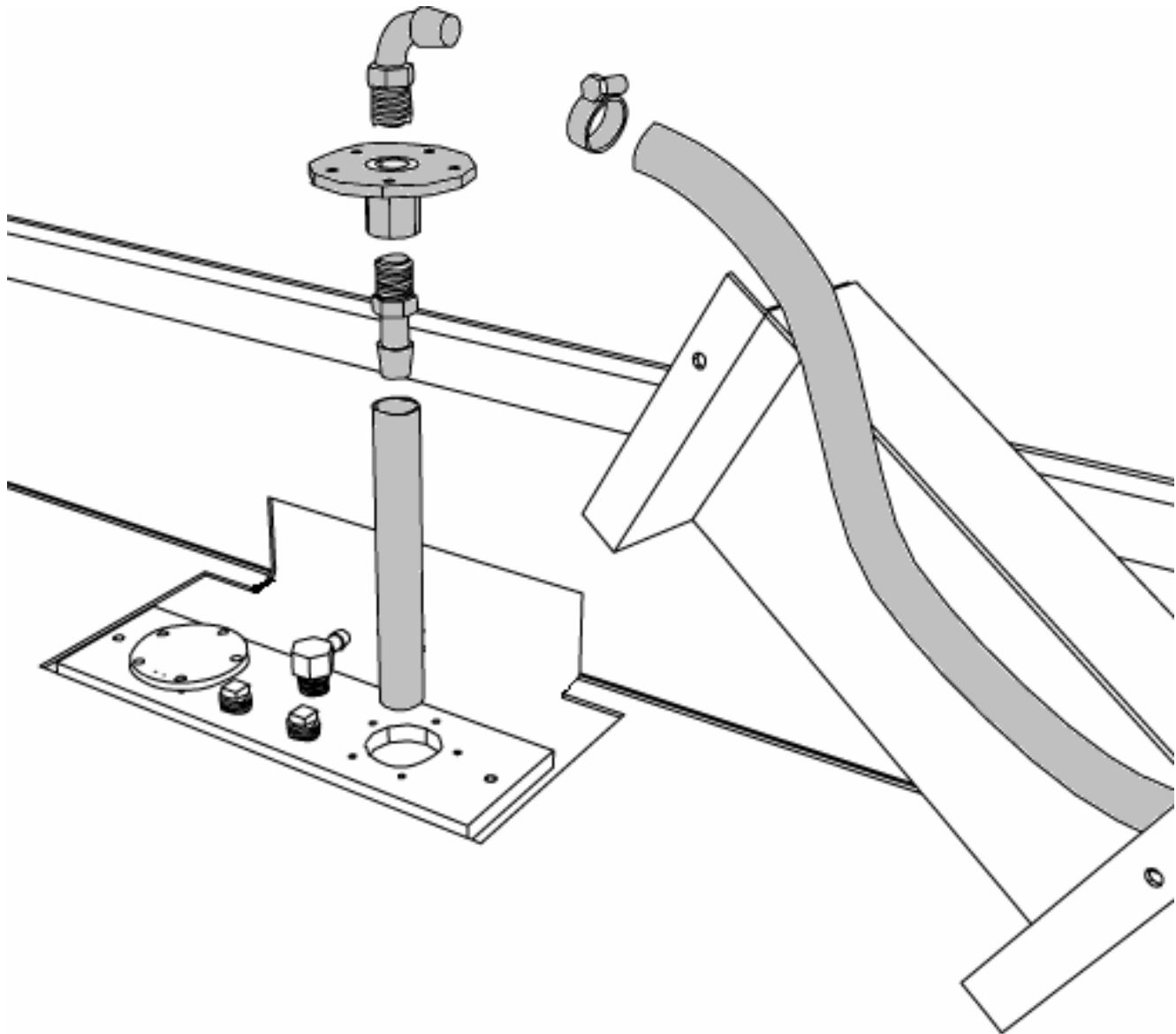

Being sure to use thread sealant on all fittings, thread the ½” hose elbow fitting (*item 6*) into the flush side of the Pick-up Adapter (*item 4*). On the opposite side, thread the ½” straight hose fitting (*item 5*) to the Pick-up Adapter. Push the 12” section of ½” Fuel Pick-up hose (*item 10*) onto the end of the straight fitting. Drop the ‘Pick-up Assembly’ into the open Plate hole on passenger side, and fasten to the plate with the five 8-32 machine screws. **NOTE* THE HOLE PATTERN ON BOTH THE PLATE AND THE PICKUP ADAPTER ARE NOT CONCENTRIC AND MUST BE KEYED ALIKE TO ALIGN THE SCREWS.** Attach the 24” section of Fuel Hose (*item 9*) to the end of the elbow fitting on the Pick-up Assembly using provided Hose Clamp (*Item 11*). Lace the Fuel hose through the passenger side hole of the Sending Unit Cover, and reinstall the Cover to the Sending Unit Plate.

IF YOU HAVE A 60 GALLON COMBO, SKIP TO PAGE 7.

3. PLUMBING THE TP9 PUMP

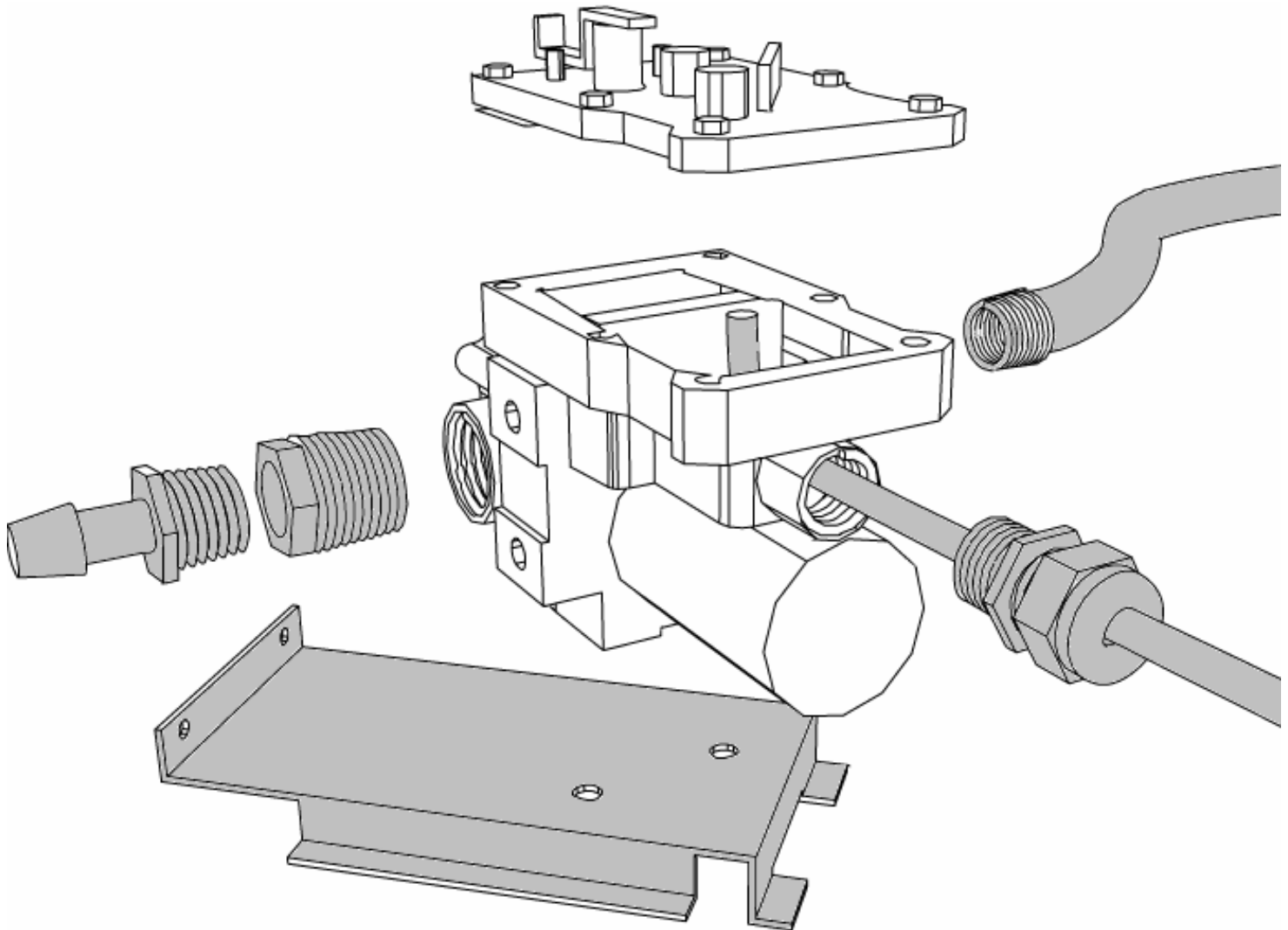

Remove the electrical cover of the TP9 Pump (*Item 1*) by removing the six 1/4-20 bolts from the side that has the ON/OFF rocker switch. Feed the 12VDC Electrical Cord (*Item 12*) through the CordGrip (*Item 13*) and through the electrical access hole in the TP9 Pump. Cut back the wire insulation and strip approximately 1/2" of the wire housing on each of the black and red wires. Attach the Cord wires to the internal Pump wires (*alike colors*) using the Butt-Connectors (*Item 14*). Reinstall the electrical cover being sure to seat the gasket underneath. Tighten the end of the Cordgrip to cinch up on the cord. This prevents cord pulling. Bolt Pump Mounting Bracket (*Item 15*) to the bottom of the TP9 Pump using the two 3/8" x 1/2" bolts (*item16*). Being sure to use thread sealant on all fittings, thread the Pump Hose (*Item 2*) into the TP9 Pump. Thread the Reducing Bushing (*Item 7*) into the TP9 Pump, then thread the 3/4" Barbed Fitting (*Item 8*) into the Reducing Bushing.

4. CONNECTING TP9 PUMP ASSEMBLY TO THE PICKUP ASSEMBLY

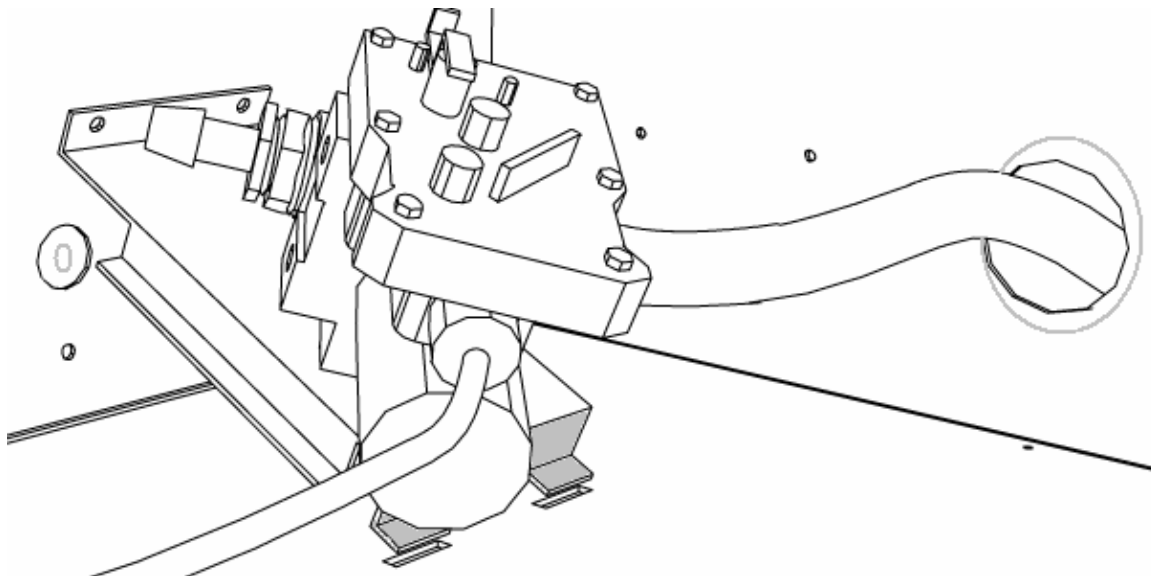

Feed the Pump Hose through the Grommet on the passenger side of the box. Align the Pump Assembly as shown, then slip the front tabs (*shaded*) of the Pump Bracket into the two slots in the bottom of the box. Slide the Bracket forward and rotate down until the Bracket sits flush. Align and bolt the Bracket to the back of the toolbox using the bolts, washers and nuts provided (*Items 17,18,19*).

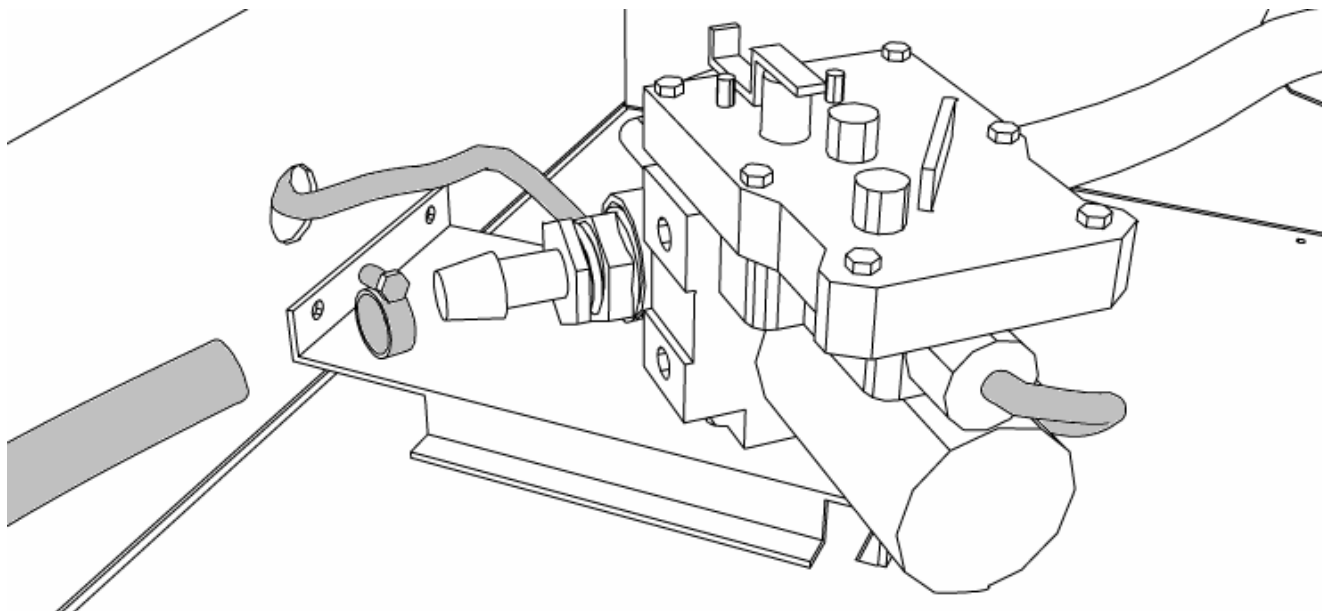

Feed the 12VDC Cord through the Grommet in the back of the toolbox. Attach the 24" section of Fuel Hose from the Pick-up Assembly to the Barbed Fitting on the Pump Assembly (Hose may be trimmed as necessary) using provided Hose Clamp (Item 11). Using thread sealant, attach Pump Handle to the end of the Pump hose. Connect 12VDC wire to fused 12V source.

**3b. CONTINUED FROM PAGE 4;
PLUMBING/ELECTRICAL FOR 60 GALLON COMBO.**

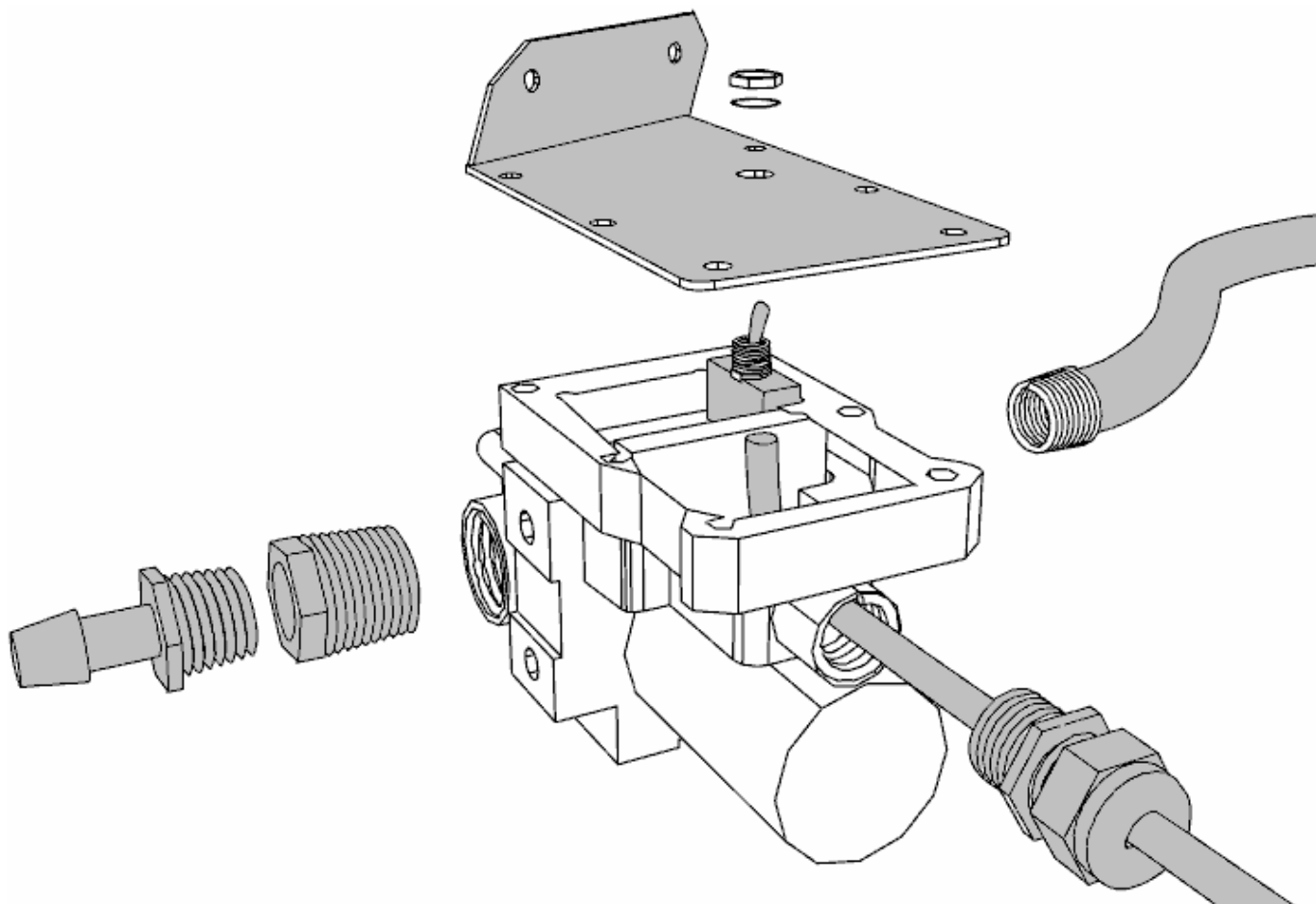

Remove the electrical cover of the TP9 Pump (*Item 1*) by removing the six 1/4-20 bolts from the side that has the ON/OFF rocker switch. Feed the 12VDC Electrical Cord (*Item 12*) through the CordGrip (*Item 13*) and through the electrical access hole in the TP9 Pump. Cut back the wire insulation and strip approximately 1/2" of the wire housing on each of the black and red wires. Attach the Cord wires to the internal Pump wires (*alike colors*) using the Butt-Connectors (*Item 14*). Use a 1/4" socket driver to remove the retaining screw that anchors the flip switch bracket. Loosen the nut and washer to remove the bracket from the flip switch. Gently rotate the switch to a vertical position being careful not to break any electrical connections and let sit against pump body. Align and install the Pump mounting bracket (*Item 15*) by fastening the cover with the six 1/4-20 bolts. Refasten the switch with washer and nut. Tighten the end of the CordGrip to cinch up on the cord. Being sure to use thread sealant on all fittings, thread the Pump Hose (*Item 2*) into the TP9 Pump. Thread the Reducing Bushing (*Item 7*) into the TP9 Pump, then thread the 3/4" Barbed Fitting (*Item 8*) into the Reducing Bushing.

4b. CONNECTING TP9 PUMP ASSEMBLY TO THE PICKUP ASSEMBLY

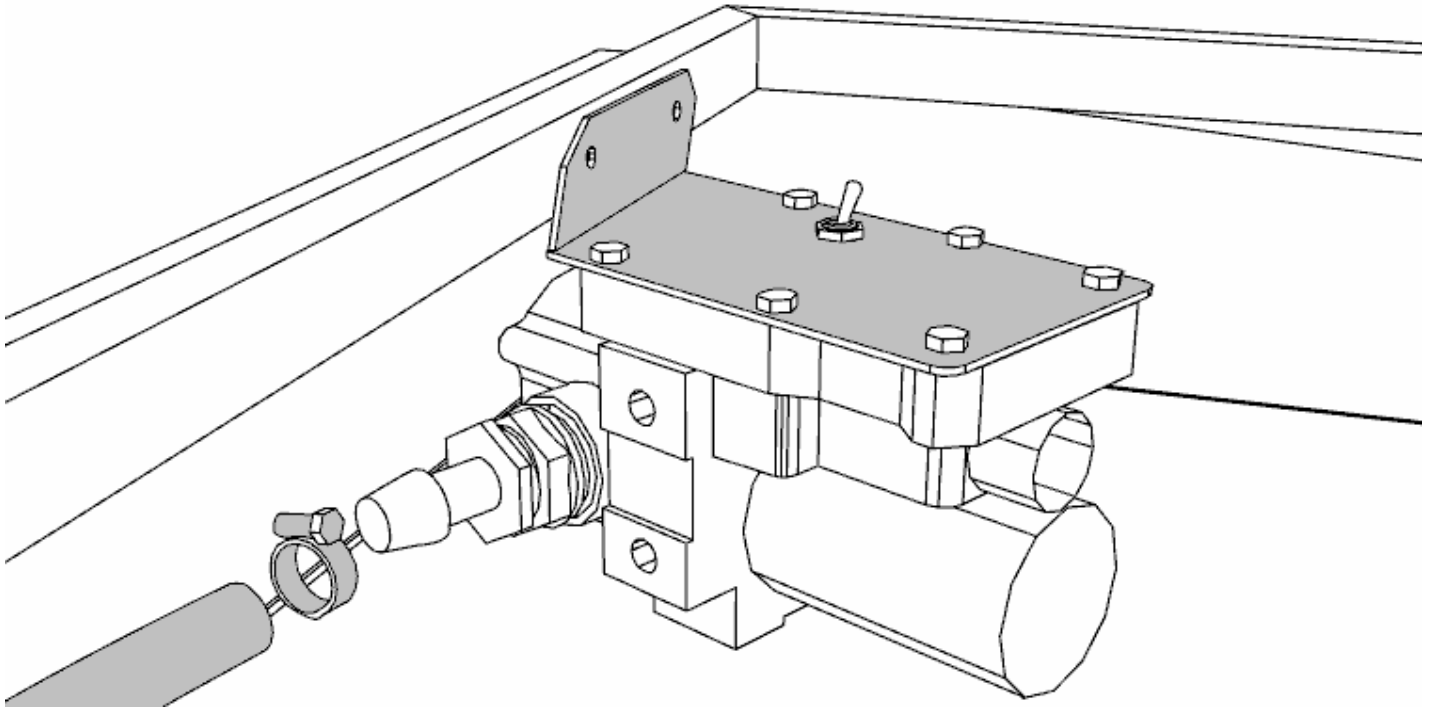

Allowing enough room for the Pump Hose and Pump handle, the bracket can be mounted anywhere on the passenger side of the rear rain channel of the box. Fasten bracket to the rain channel with either self tapping screws or bolts. Attach the 24" section of Fuel Hose from the Pick-up Assembly to the Barbed Fitting on the Pump Assembly (Hose may be trimmed as necessary) using provided Hose Clamp (Item 11). Using thread sealant, attach Pump Handle to the end of the Pump hose. Connect 12VDC wire to fused 12V source.